

● 垂直直线齿轮箱
Linear type gear head-Vertical

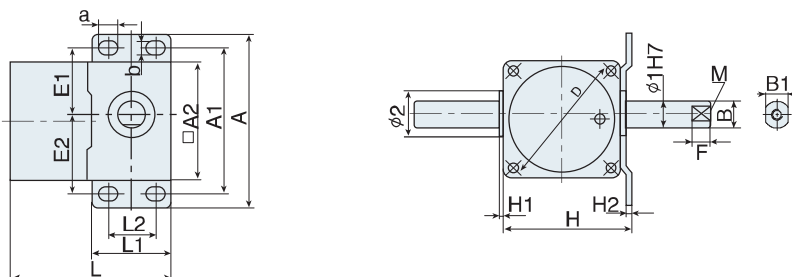

型号	L	L1	L2	A	A1	A2	E1	E2	a	b	$\phi 1$	$\phi 2$	D	f	B	B1	H	H1	H2	M
60LF	81.5	40	24	88	74	60	34.5	39.5	9.5	6.5	14	24	70	9	13	12	66	2	3	5
70LF	84	40	24	110	90	70	47	43	9.5	6.5	14	26	82	9	12.5	12	76	3	2.5	5
80LF	96.5	53.5	30	120	100	80	45	55	10	8	20	32	94	10	19.7	17	82	3.2	12	10
90LF	121	55	29	140	116	90	53	63	14	12	25	40	104	13	24.7	21	95	3.2	18	12

● 水平直线齿轮箱
Linear type gear head-Horizontal

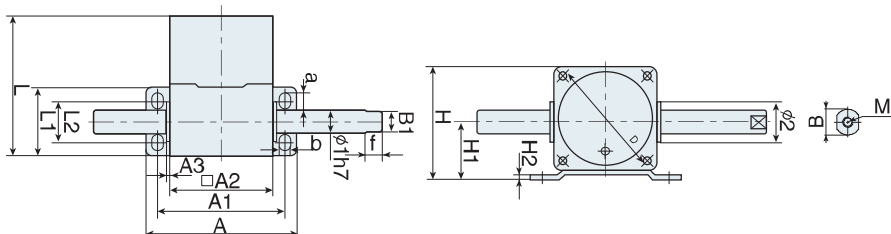

型号	L	L1	L2	A	A1	A2	A3	a	b	$\phi 1$	$\phi 2$	D	f	B	B1	H	H1	H2	M
60LB	81.5	40	24	88	74	60	2	9.5	6.5	14	24	70	9	13	12	66	33.5	3	5
70LB	84	40	24	110	90	70	3	9.5	6.5	14	26	82	9	12.5	12	76	39	2.5	5
80LB	96.5	53.5	30	120	100	80	3.2	10	8	20	32	94	10	19.7	17	82	37	12	10
90LB	121	55	29	140	116	90	3.2	14	12	25	40	104	13	24.7	21	95	45	18	12

● 直线齿轮箱参数
Parameter of the Linear type gear head

型号 Type	速度 (mm/s) Speed	最大搬运质量(kg) Max.handling quality	齿条有效行程(mm) Rack effective travel	电机机座号 Frame size	功率(W) Power
60LF(B)	10~100	20	100~500	60	6
70LF(B)	10~100	40	100~500	70	15
80LF(B)	10~100	70	100~700	80	25
90LF(B)	10~100	140	100~1000	90	40~120